

# GXP® PLUS

INSULATION AND PROTECTION OF FOUNDATION WALLS

## APPLICATIONS

The GXP® PLUS membrane made of high density polyethylene (HDPE), basis weight 400-1200 g/m<sup>2</sup>, which is perfect at protecting, insulating and securing the underground sections of foundations and walls as well as eliminating the capillary rising of water.

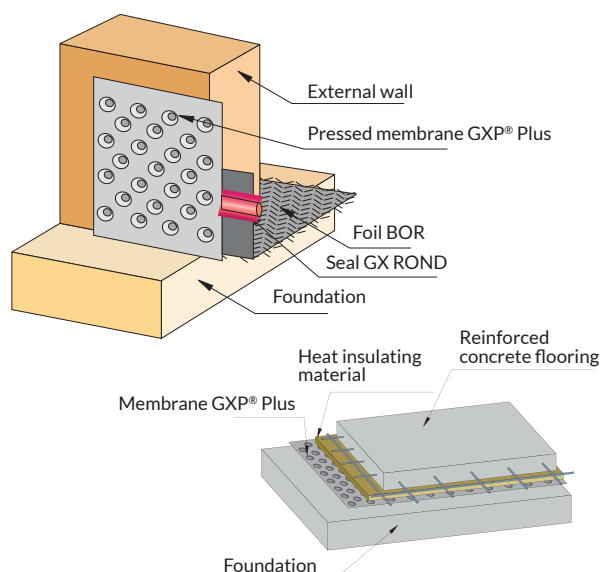

- EASY, EFFECTIVE AND FAST ASSEMBLY
- MAINTAINED LINEARITY
- 100% JOINT LEAKTIGHTNESS

## PATENTED INNOVATIVE JOINT SYSTEM

An innovative joining system, the so-called snap lock, which has been patented and introduced into the market by GrilTEX Poland, improves the effectiveness and functionality of pressed foils, increasing their range of applications in the building industry.

## ACCESSORIES

Nails and pads



Mounting profile 2 m



Butyl tape



Dowels for slats - mounting for EPS



Dowels for EPS



## ADVANTAGES

- ▶ high compressive and tear strength
- ▶ moisture management of the foundations through air circulation
- ▶ effective protection of the existing insulation
- ▶ additional heat insulation of the foundations
- ▶ it also constitutes waterproofing (elevated tightness class W1)
- ▶ possibility of producing rolls of up to 70 mm in length
- ▶ easy assembly owing to a wide range of accessories



## CHEMICAL RESISTANCE

It is resistant to chemical substances, fungi, roots and bacteria present in the ground. It is completely neutral to the natural environment.

TECHNICAL DATA						
	0,4	0,5	0,6	0,8	1,0	1,2
Weight m <sup>2</sup>	400 g/m <sup>2</sup>	500 g/m <sup>2</sup>	600 g/m <sup>2</sup>	800 g/m <sup>2</sup>	1000 g/m <sup>2</sup>	1200 g/m <sup>2</sup>
Material thickness	400 μm	500 μm	600 μm	800 μm	1000 μm	1200 μm
Compression strength	120 kN/m <sup>2</sup>	230 kN/m <sup>2</sup>	300 kN/m <sup>2</sup>	400 kN/m <sup>2</sup>	500 kN/m <sup>2</sup>	600 kN/m <sup>2</sup>
Embossing height	8 mm	8 mm	8 mm	8 mm	8 mm	8 mm
Number of embossings	1860/m <sup>2</sup>	1860/m <sup>2</sup>	1860/m <sup>2</sup>	1860/m <sup>2</sup>	1860/m <sup>2</sup>	1860/m <sup>2</sup>
Air volume between textile and membrane	5,3 l/m <sup>2</sup>	5,3 l/m <sup>2</sup>	5,3 l/m <sup>2</sup>	5,3 l/m <sup>2</sup>	5,3 l/m <sup>2</sup>	5,3 l/m <sup>2</sup>
Temperature resistance	-40 to +80°C	-40 to +80°C	-40 to +80°C	-40 to +80°C	-40 to +80°C	-40 to +80°C
Maximal width	4,0 m	4,0 m	4,0 m	4,0 m	4,0 m	4,0 m
Standard roll sizes	1,0 x 20 m 1,5 x 20 m 2,0 x 20 m 4,0 x 20 m	1,0 x 20 m 1,5 x 20 m 2,0 x 20 m 4,0 x 20 m	2,0 x 20 m 4,0 x 20 m	2,0 x 20 m 4,0 x 20 m	2,0 x 20 m 4,0 x 20 m	2,0 x 20 m 4,0 x 20 m